

UNO Filter Unit

(Funnel sold separately)

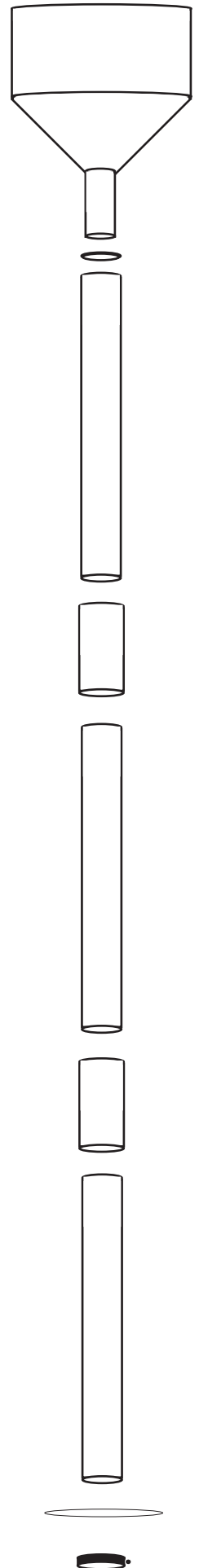

Parts Included

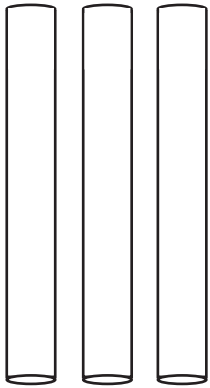

50cm Rigid Filter Tube x 3

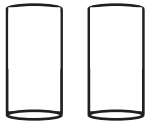

Soft Connector Sleeve x 2



Funnel Holder (Red) x 1



RF Hose Clamp (Metal) x 1

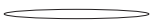

Filter Paper x 4

To assemble your filter unit, place a connector sleeve approximately half way onto one of the rigid filter tubes. Then, slide a second rigid filter tube into the open end of the connector sleeve. Repeat this process to assemble all three filter tubes, creating a 150cm (60") filter assembly.

To use your filter unit, place the desired number of filter papers (usually 2-3 professional filter papers) over the bottom of your filter assembly, sliding your RF Hose Clamp over the filter papers, causing them to fold over the end of your filter unit. Tighten the RF Clamp to securely hold the filter papers in place. Place the funnel holder on the top of your filter unit, making sure that it is fully seated in place. Slide your funnel into the filter unit, and push down to securely seat the funnel to the funnel holder, creating a seal between your funnel and filter unit.